

REV.	DESCRIPTION	DRAWN	CHECKED	APPROVED
A	NEW RELEASE	LJC 10/28/13'	LJC 10/28/13'	LJC 10/28/13'
B	DIMENSION CHANGE	Kevin 01/28/16'	Andy_H 01/28/16'	LJC 01/28/16'
C	DRAWING UPDATE	JLZ 02/24/17'		

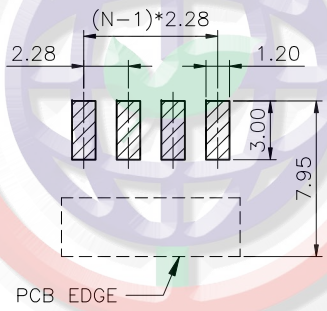
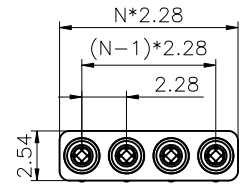
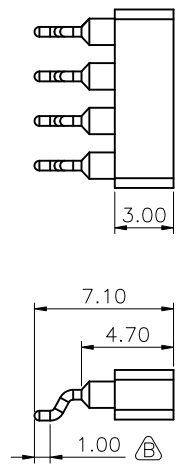

RECOMMEND PCB LAYOUT TOLERANCE=±0.05mm

Female

NOTES:

- Materials:
  - Insulator: High Temperature 260°C, UL94-HB or V0 Rated, color of white or black. RoHS, REACH compliance.
  - Pin: Copper Alloy, Plating Matt Tin or Gold.
  - Clip: Beryllium Copper, C17200, Full Gold plating.
- Specifications:
  - Temperature Range: -55~+125°C. (Full Gold Plating).
  - Contact Resistance: 10mΩ maximum.
  - Insulation Resistance: 1000MΩ minimum.
  - Dielectric Withstanding Voltage: 500V AC 1 minute.
  - Voltage Rating: 24V AC/DC.
  - Current Rating: 3A max per pin.
  - Application insert pin: Ø0.381~Ø0.635mm.
  - Resistance to soldering heat: 260°C, 3-5seconds.
  - Durability: 1000 cycles min.
  - Insertion Force: 270g Maximum per Pin.
  - Withdrawal Force: 90g Minimum per Pin.
  - Packing Type: 13" Tape On Reel.
- Product Number Code:

DS1137-09 - X X X X X X

- Packing Type  
R: Tape On Reel.
- Clip plating(Female Only)  
8: Full gold flash.  
C: Full 3u" gold.
- Pin plating  
6: Full tin.  
8: Full gold flash.
- Housing Color  
W: White  
B: Black  
V: Ivory
- Connector Type  
F: Female  
M: Male
- No. of positions  
2: 2p ~ 10: 10p

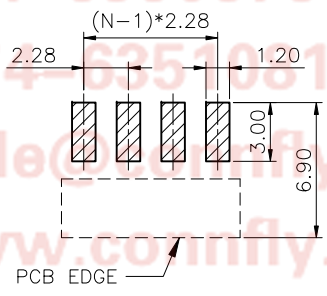
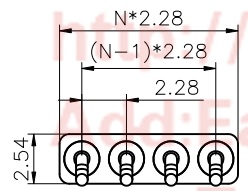
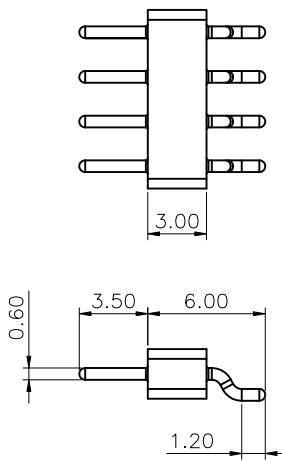

RECOMMEND PCB LAYOUT TOLERANCE=±0.05mm

Male

Tel:86-574-63508787  
 Fax:86-574-63510817  
 E-mail:sale@connfly.com  
 http://www.connfly.com  
 Add:East Industrial Zone KuangYan  
 Town Cixi Ningbo China  
 P.C:315333

GENERAL TOLERANCE		ANGLE TOLERANCE		PROJECTION		TITLE	2.28mm LED Series Male & Female SMT Type H=2.54mm(Clip = 4 Fingers)	
X.	±0.60	X.	±5°	UNITS	mm	SHEET	A4	
.X	±0.38	.X	±3°	SHEET SIZE	A4	SERIES	DS1137-09 SERIES	
.XX	±0.25	.XX	±2°	晨翔电子有限公司 <b>CONNFLY CONNFLY ELECTRONIC CO., LTD</b>				
DRAWING TYPE		CUSTOMER						
SCALE	1:1	SHEET	1 OF 1					
DRAWING NO.		C-DS1137-09-XXXXXX-C						